

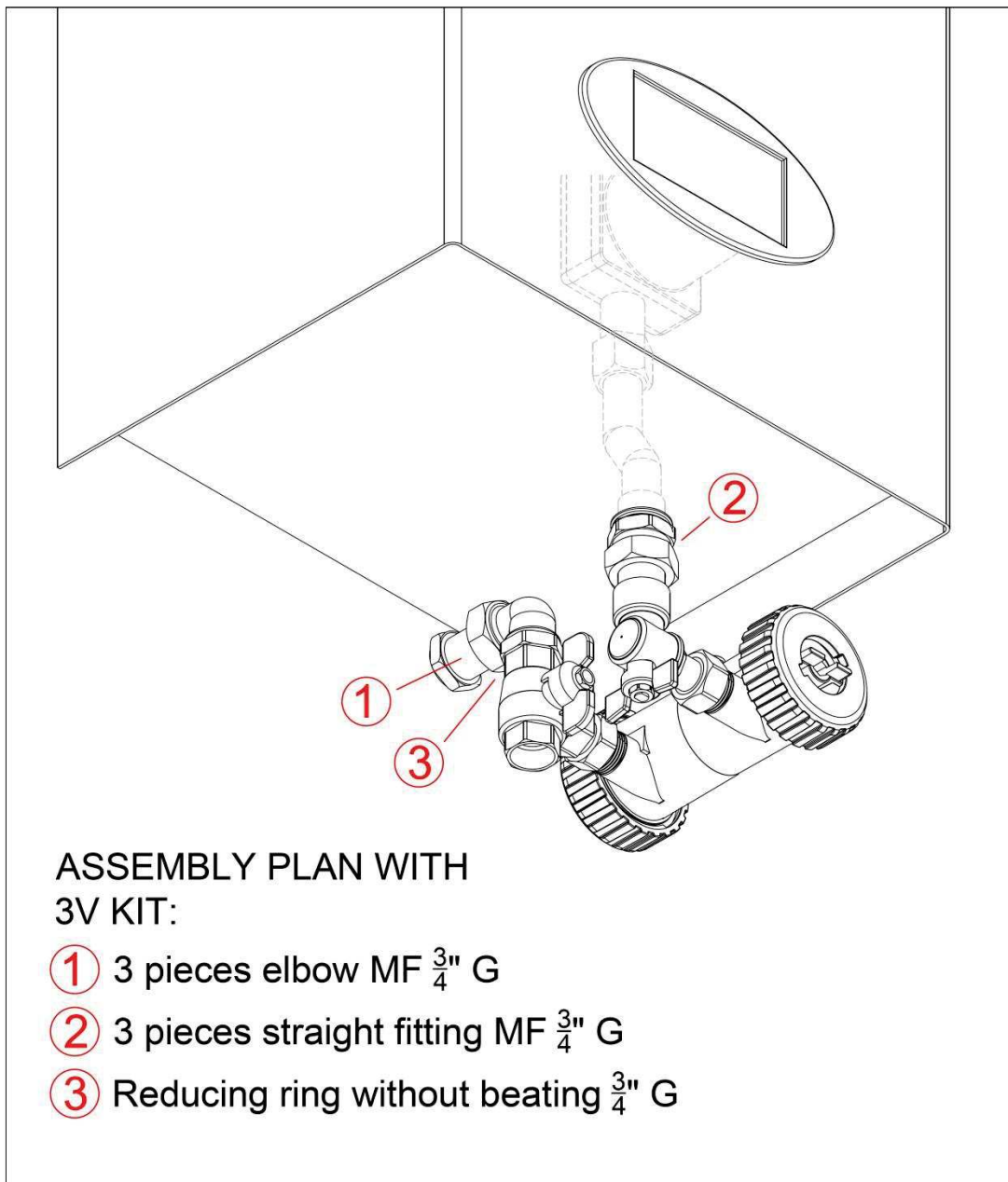

INSTALLATION

1 – INSTALLATION WITH 3-V KIT (RIGHT SIDE)



2 – INSTALLATION WITH 3-V KIT (LEFT SIDE)

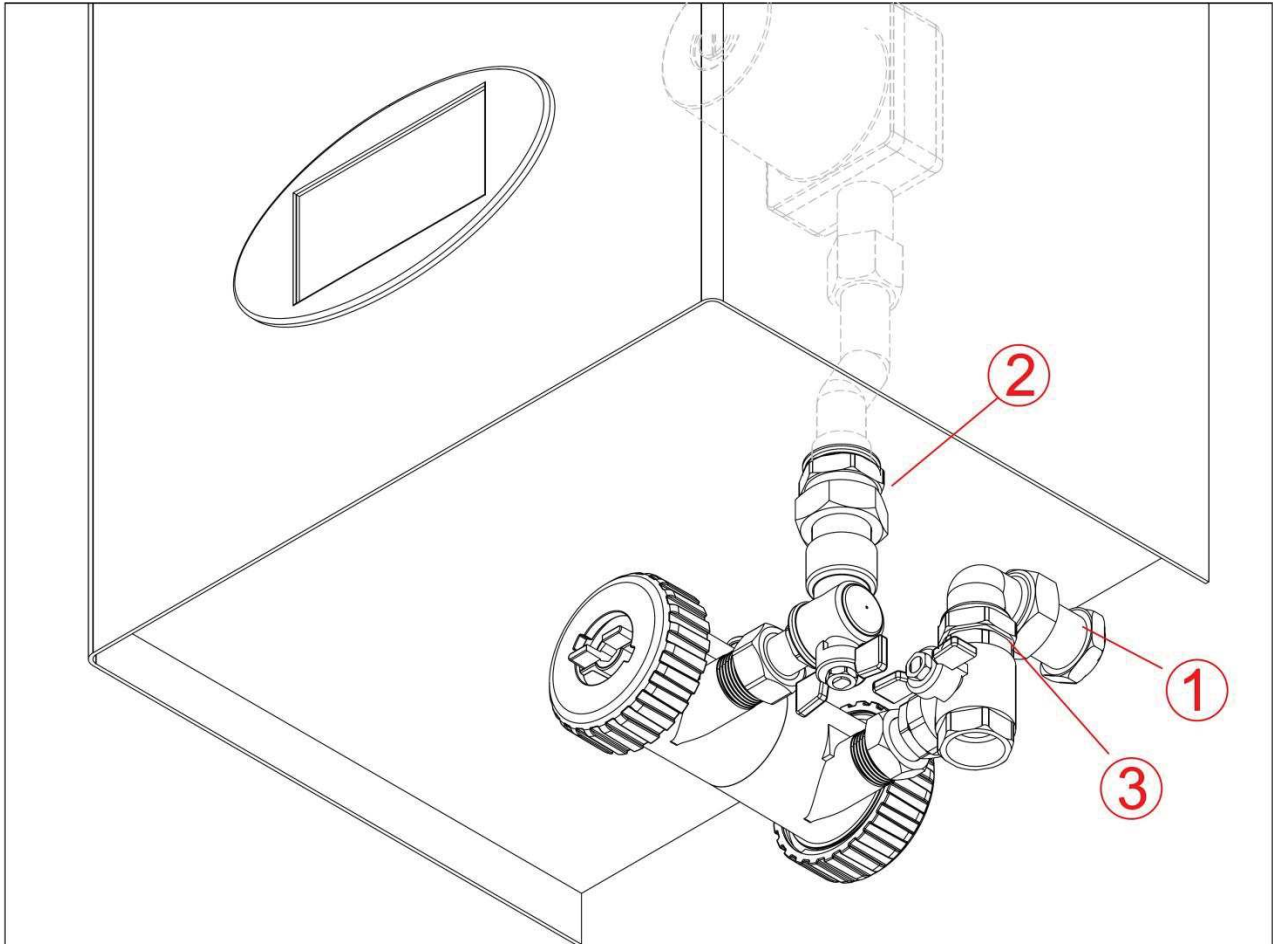

ASSEMBLY PLAN WITH
3V KIT:

- ① 3 pieces elbow MF $\frac{3}{4}$ " G
- ② 3 pieces straight fitting MF $\frac{3}{4}$ " G
- ③ Reducing ring without beating $\frac{3}{4}$ " G

3 – INSTALLATION WITHOUT 3-V KIT

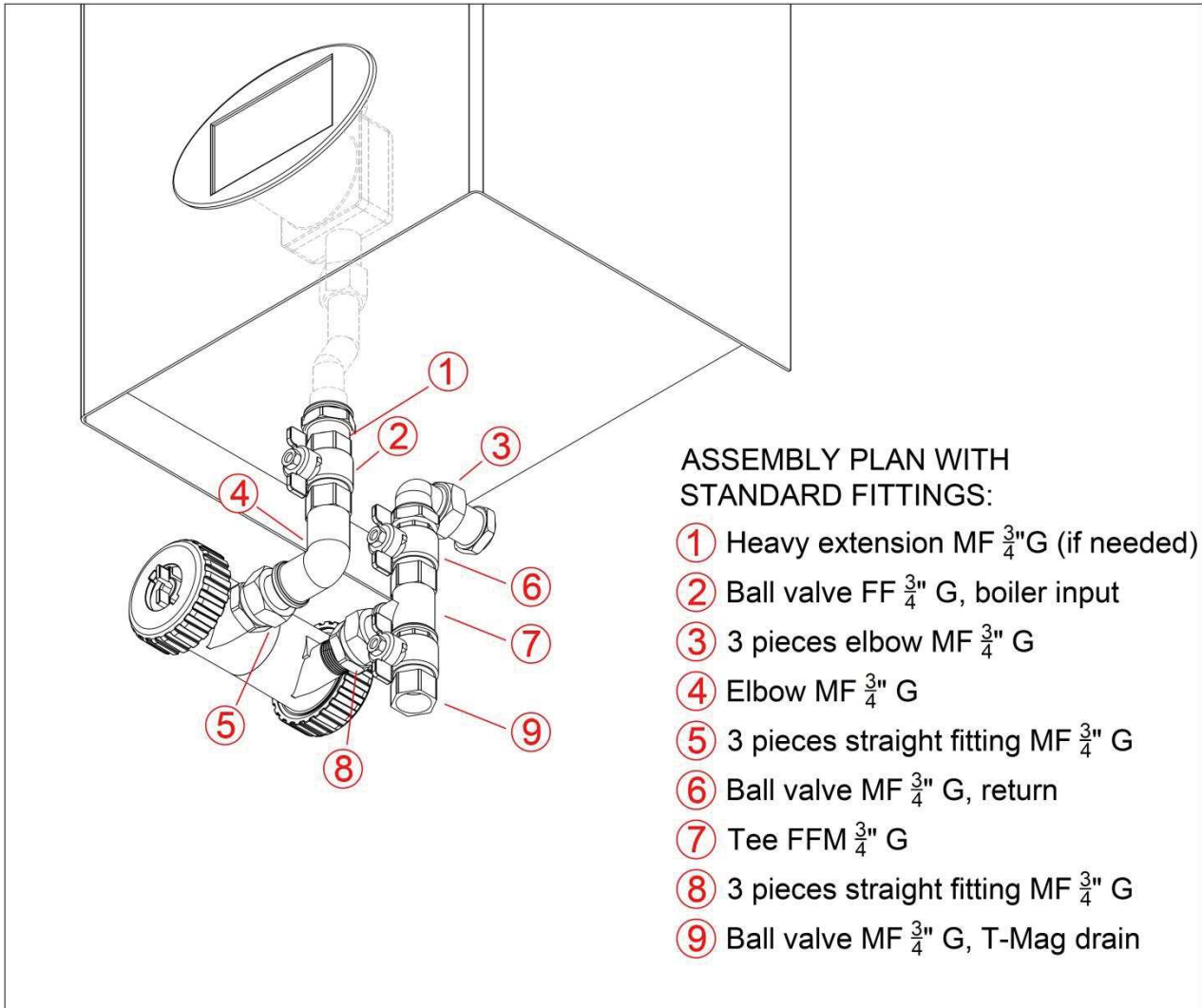

4 – RECESSED BOILER WITHOUT 3-V KIT

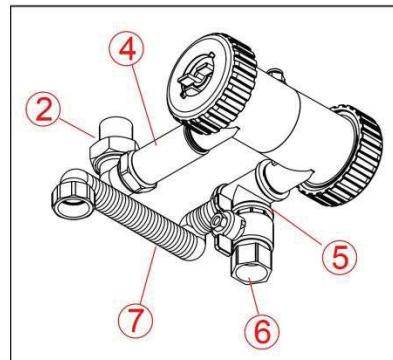
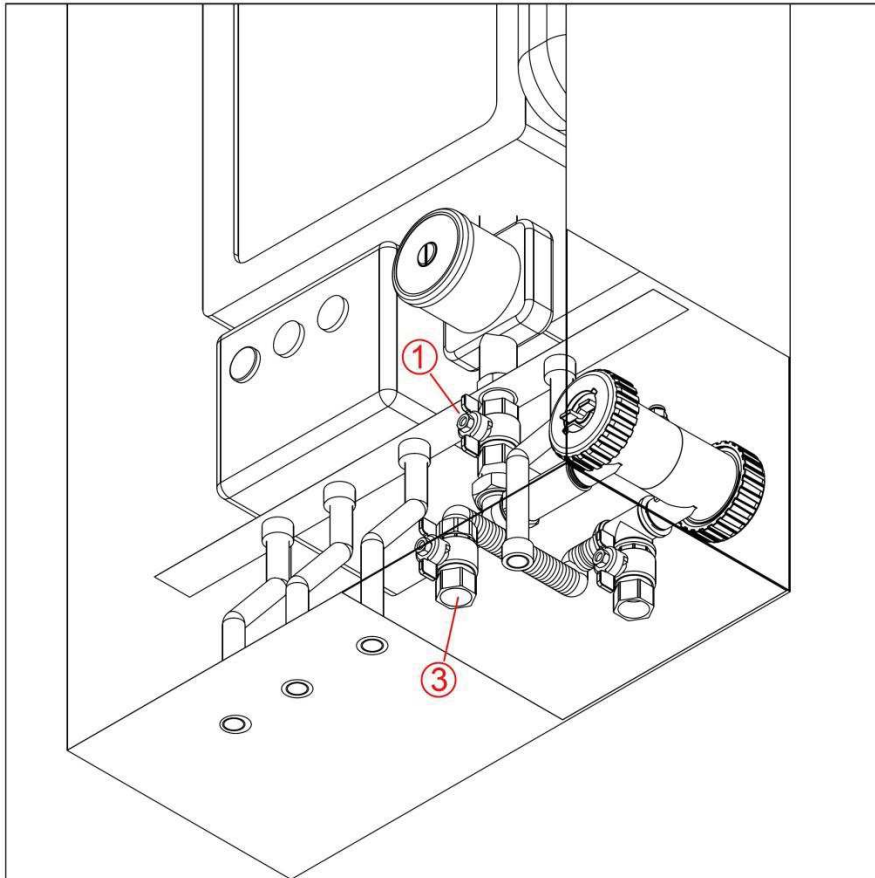

ASSEMBLY PLAN WITH STANDARD FITTINGS:

- ① Ball valve MF $\frac{3}{4}$ " G, boiler input
- ② 3 pieces elbow MF $\frac{3}{4}$ " G
- ③ Ball valve MF $\frac{3}{4}$ " G, return
- ④ Heavy extension MF $\frac{3}{4}$ " G
- ⑤ Tee FFF $\frac{3}{4}$ " G
- ⑥ Ball valve MF $\frac{3}{4}$ " G, T-Mag drain
- ⑦ Flexible water hose MF $\frac{3}{4}$ " G

**RECESSED
BOILER**

5 – VERTICAL INSTALLATION WITH 3-V KIT

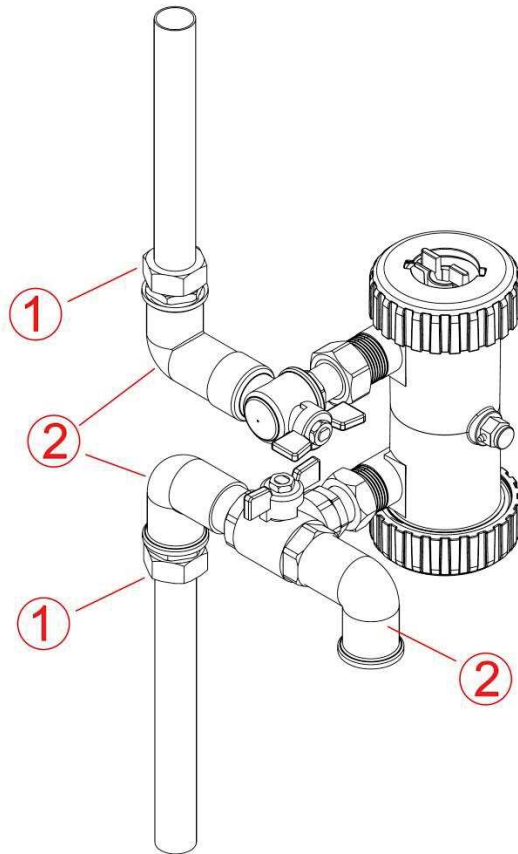

ASSEMBLY PLAN WITH 3V KIT:

- ① Male fitting $\frac{3}{4}$ " G/copper hose, iron hose...
- ② Elbow MF $\frac{3}{4}$ " G

